

GENERAL NOTES:

1. This Map has been prepared pursuant to the Regulation of Connecticut State Agencies Section 20-300b-1 through 20-300b-20 and the Standards for Surveys and Maps in the State of Connecticut as adopted by the Connecticut Association of Land Surveyors, Inc. on Sept. 28, 1998.
2. This Survey conforms to Class A-2.
3. The Type of survey performed is a Limited Property / Boundary Survey, and is intended to be Existing Building Location Survey.
4. Boundary determination is based upon a Dependent Resurvey (see MAP REFERENCES and Record Deeds.)
5. North Arrow is based on Map Reference # 1.
6. This map is NOT VALID without a LINE SIGNATURE and EMBOSSED SEAL.
7. This map is NOT VALID if altered or used by any party other than the one depicted in title block of this map.
8. Property Lines Established According to Record Deeds as exist
9. Physical Features Such as Stone Walls, Wire Fences, Monuments, Iron Pins or Pikes, Etc. taken under consideration to establish current deed lines.
10. Underground Utility, Structure and facility Locations depicted and noted hereon, have been compiled, in part, from record mapping supplied by the respective utility companies or government agencies, from parole testimony and from other sources. These Locations must be considered as approximate in nature. Additionally, other such features may exist on the site, the existence of which are unknown to this firm. The size, location and existence of all such features must be field determined and verified by the appropriate authorities prior to construction. CALL BEFORE YOU DIG 1-800-922-4455.

MAP REFERENCES:

1. RECORD MAP # 1644

N/F  
MARY GUERISO  
VOL. 309 , PAGE 25

LEGEND

	PROPERTY LINE
	EXISTING 2' CONTOUR
	EXISTING 10' CONTOUR
	EXISTING SPOT ELEVATION
	EXISTING STONE WALL
	WETLAND BOUNDARY
	PROPOSED 2' CONTOUR
	PROPOSED 10' CONTOUR
	PROPOSED SPOT ELEVATION
	DEEP TEST HOLE
	PERC HOLE

NOTE:  
SEPTIC SYSTEM AND DRAINAGE PROPOSED ON  
03/13/06

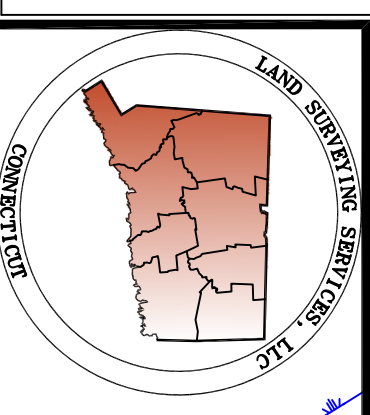

LAND SURVEYING  
SERVICES, LLC  
135 FAIRCHILD AVENUE  
FAIRFIELD, CONNECTICUT 06825  
TEL. (203) 522-4177  
FAX: (203) 615-0123  
EMAIL: info@realteam.com

TITLE BLOCK  
ASSESSORS MAP # 38063 PARCEL 194A  
APPLICANT: SHANE A. OWEN  
PROPOSED SOLAR ARRAY  
To the best of my knowledge and belief this map is substantially correct and reads true.  
MATH HEALY, L.S. # 18139

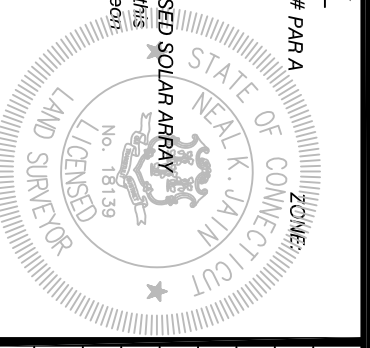

DATE	DESCRIPTION	REVISIONS
10/04/2021	PROJ. SOLAR ARRAY	
03/02/2021	REVISED JARNOV	
12/19/2019	FINAL AS-BUILT	
06/10/2016	SEPTIC AS-BUILT	
11/28/15	PROPOSED SHADOWING	
01/28/14	SITE PLAN	

IMPROVEMENT LOCATION SURVEY  
PREPARED FOR  
**MATTHEW HEALY**  
40 BRADLEY ROAD, WESTON, CONNECTICUT  
SCALE: 1" = 30'  
DATE: DEC. 17, 2004.