

116 WILDEWOOD Rd
 Septic System Repair Plan
 BY Joseph P. Morton
 Lic 3446 1" = 30'
 203-948-5540 12-13-2020
 (revised plan)

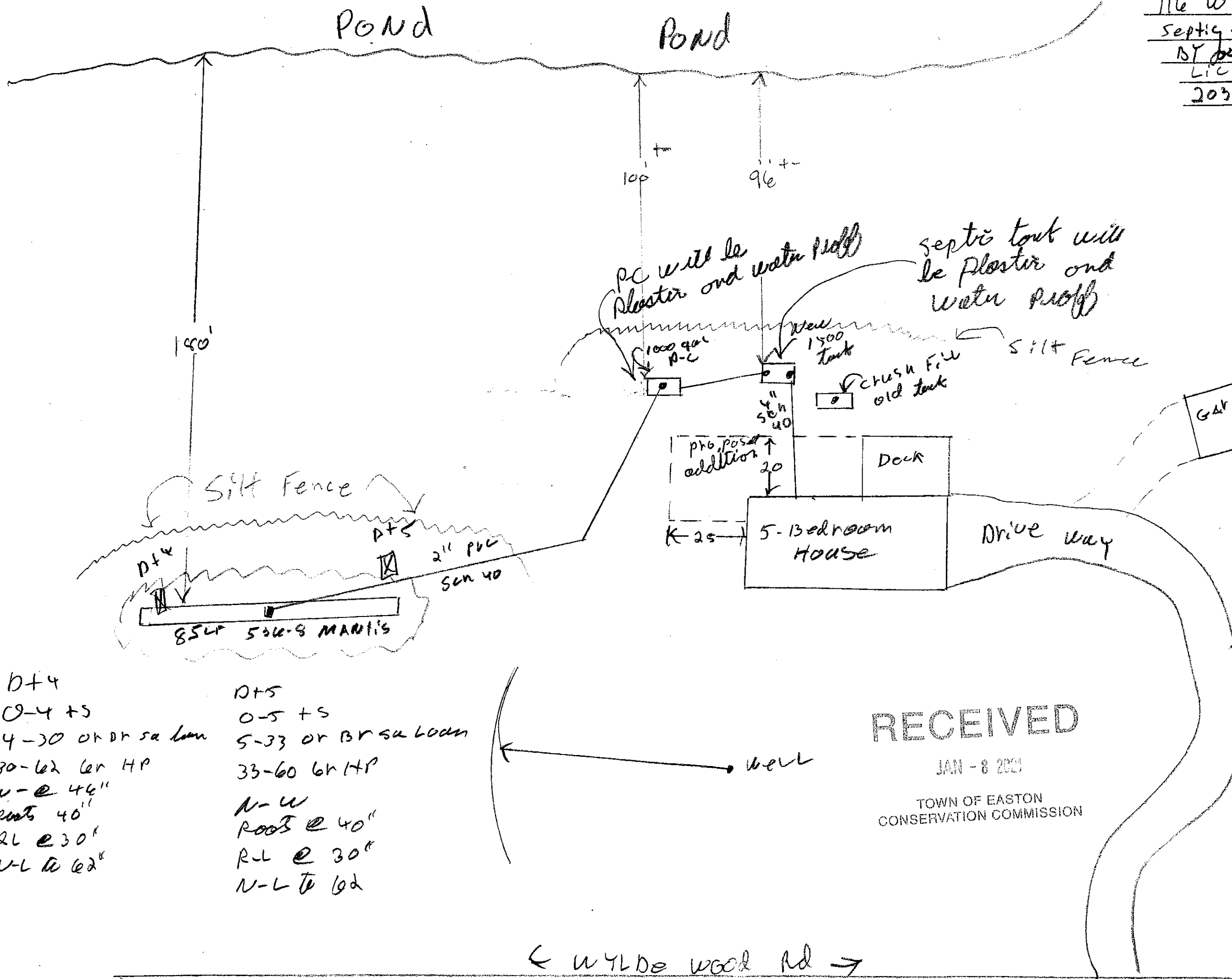

- Notes
- 1) 5-Bedroom House
 - 2) 1-20 per A
 - 3) RL @ 30"
 - 4) Slope 6-8
 - 5) Crush Fill old tank
 - 6) New 1500 tank
 - 7) New 1000 P-L
 - 8) Strip top soil Replace with 12" Septic Sand
 - 9) 900 SF Reg
 - 10) 935 shown with 85 SF of 536-8 manhole units
 - 11) MLDJ
 HF PF PF
 29 X 2 X 125
 = 70 LF Reg
 85 SF shown

D+4
 0-4 +5
 4-30 or Dr sa loan
 30-62 Gen HP
 W-@ 46"
 Roots 40"
 RL @ 30"
 N-L @ 62"

D+5
 0-5 +5
 5-33 or Br sa loan
 33-60 Gen HP
 N-W
 Roots @ 40"
 RL @ 30"
 N-L to 62"

RECEIVED
 JAN - 8 2021
 TOWN OF EASTON
 CONSERVATION COMMISSION

APPROVED
 DEC 30 2020
 Health Department
 BY: Joseph P. Morton (with conditions)
 See permit to construct comments

← WILDE WOOD Rd →